

ITEM # CN1-1-7, CHECK VALVES - CARBON STEEL



NPTF & SAE Connections.
 Carbon Steel with Zinc Chromate Plating (RoHS Compliant).
 Available in 7 PSI & 65 PSI Spring Cracking Pressures.
 Metal to Metal Seat
 Hardened Poppet.
 Temperature Range -4 °F to +176 °F.

SPECIFICATIONS

Dimension Drawing

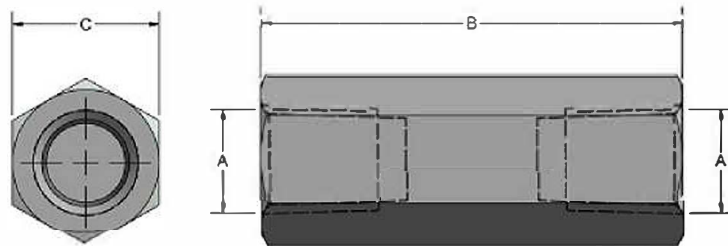

Stainless Steel Check Valves

Thread Type	NPTF Pipe Thread
Thread Size	1 in
Material	Carbon Steel
Cracking Pressure	7 psi
Dimension B	4.330 in
Dimension B	1.610 in
Maximum Pressure	5000 psi
Maximum Flow	40 gpm
Waight	1.6 lb
Tempereture Range	-4 to +176 °F
Industry Standarts	RoHS Compliant
Plating	Zinc Chromate

* Please visit Bertrem Valve's Website to see more valves that address industry needs with uncompromising quality